

CareStart Access Bio COVID-19 Test

AT-HOME TESTING INSTRUCTIONS



Link to instructional video: <http://tiny.cc/carestart>

1

CLEAN HANDS

Wash your hands thoroughly for at least 20 seconds



2

TEST MATERIALS

Remove the testing materials from the tray. You will need a test cassette, swab, vial, and vial cap.



3

TEST CASSETTE

Remove test cassette and place it on a flat, clean surface



4

PREPARE EXTRACTION VIAL

Carefully peel the aluminum foil seal off of the vial while keeping it upright. Place it in the tray so it is standing upright.



5

SWAB YOUR NOSTRILS

Remove the swab from its package without touching the tip of the swab. Gently insert the swab no more than 3/4 inch into your nostril. Slowly rotate the swab in 5 circles for 15 seconds. Then repeat in the other nostril for another 15 seconds.

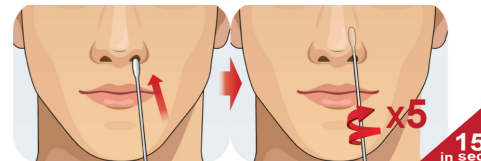

6

PLACE SWAB IN EXTRACTION VIAL

Place your swab in the vial, then rotate the swab vigorously at least 5 times.



7

REMOVE AND SQUEEZE SWAB

Remove the swab by rotating against the extraction vial while squeezing the sides of the vial to release the liquid from the swab. Discard the swab.

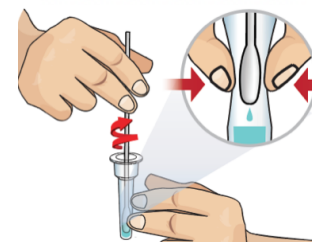

8

CLOSE VIAL

Close the vial by pushing the cap firmly onto the vial

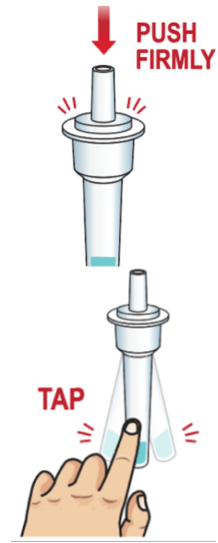

9

MIX VIAL

With your finger, mix thoroughly by flicking the bottom of the vial

10

ADD DROPS TO CASSETTE

Invert the extraction vial and hold the sample vertically above the sample well. Squeeze the vial gently. Allow three drops of sample to fall into sample well.

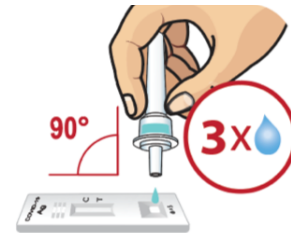

11

READ RESULTS AFTER 10 MINUTES

After 10 minutes you can read the test results. The test result should not be read after 15 minutes.

Do not move or lift the test cassette during this time



12

POSITIVE

A positive means you have a COVID-19 infection. A positive will have a line in the 'C' section AND the 'T' section.

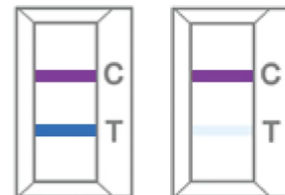

13

NEGATIVE

A negative means you are unlikely to have a COVID-19 infection. A negative result will only have a line in the 'C' section.



14

INCONCLUSIVE

If there is **NO LINE**, or if there is **ONLY** a line in the 'T' section, the test is **INVALID** - the test did not function correctly. Retest with a new test kit. If upon retesting, the test result is still invalid, contact your doctor or healthcare provider.

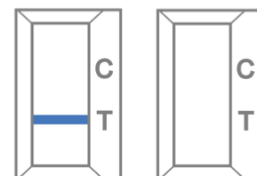

15

SHARE YOUR RESULTS ON PRIMARY.HEALTH

You may also call 650-275-5419.
<https://my.primary.health/l/caschools>

